



TWO-COLOUR

DESIGN BY MULLER VAN SEVEREN

HAY

TWO-COLOUR

Inspired by Muller Van Severen's love of materials and the different ways they can be showcased to highlight their natural beauty, the designer duo describe their Two-Colour Table series as a marriage of two materials used at their best. Inspired by the contrasts and similarities in the materials used – the Two-Colour Table features robust steel tube legs and a tabletop crafted in organic coloured Valchromat. The table's uniform silhouette and contrasting solid colour components reflect their preference to work with integrally coloured objects. Like much of Muller Van Severen's work, the Two-Colour Table achieves an elegant minimalism without seeming ordinary, using different shapes, sizes and colour combinations to offer a distinct and original expression.





PHOTO / RINGO GOMEZ

Fien Muller and Hannes Van Severen

INTRODUCING MULLER VAN SEVEREN FOR HAY

A new design collaboration with the world-renowned Belgian design wife and husband team Muller Van Severen.

[LINK TO VIDEO](#)

Muller Van Severen was founded in 2011 by Belgian artist duo Fien Muller and Hannes Van Severen. The couple has always been on an inspired quest for sculpturally interesting furniture objects, and their work sits somewhere between design and art, drawing on their passion for architecture and materials. They have won countless awards and collaborated with prestigious international museums and galleries.





Fien Muller and Hannes Van Severen in their studio in Evergem / Belgium.



Muller Van Severen's appreciation of materials is the starting point for many of their designs.



The colours for Two-Colour Table are carefully selected to ensure they penetrate the very core of the object.



Two-Colour is available in different shapes, sizes and colour combinations, all offering a distinct personality fulfilling a variety of aesthetic needs and styles.

The Two-Colour is inspired by the contrasts and similarities in the materials used – featuring robust steel tube legs and a tabletop crafted in organic coloured Valchromat.



Valchromat is made from wood fibres that are coloured individually with organic dyes to create core-through colour with a smooth, water-resistant surface.





Fien Muller and Hannes Van Severen's home in Evergem / Belgium



- TWO-COLOUR -



- TWO-COLOUR -







- TWO-COLOUR -





Please use below link to download packshots, lifestyle photos and other sales material of Two-Colour
IMAGE BANK

Please use below link for order placement and further information
HAYB2B.COM



TWO-COLOUR

PRODUCT FACT SHEET



TWO-COLOUR

DESIGN BY MULLER VAN SEVEREN, 2021

Described by Belgian designers Muller Van Severen as a marriage between two materials used at their best, the Two-Colour table series is inspired by the contrasts and similarities in the materials used. Featuring steel tube legs for optimal strength and stability, the table surface is crafted in organic coloured Valchromat – a unique kind of robust MDF material that is FSC-certified and features a water-based lacquer. Both components are united by the even thickness, creating a uniform silhouette that is disrupted by the contrasting elements of colour.

Two-Colour is available in different shapes, sizes and colour combinations, all offering a distinct personality that makes it ideal for a wide variety of environments, from cafés and restaurants to homes and office spaces.

HIGHLIGHTS

- A series of tables designed by Muller Van Severen in different shapes, sizes and colour combinations.
- The table features steel tube legs and a round or rectangular tabletop in organic coloured Valchromat.
- Valchromat is a robust FSC™-certified wood fibre material coloured throughout.
- The various colour combinations are carefully selected and represent the core of the tables.
- Knock-down frame.
- Suitable for a wide variety of private and public environments.
- Qualified for contract use.

DIMENSIONS

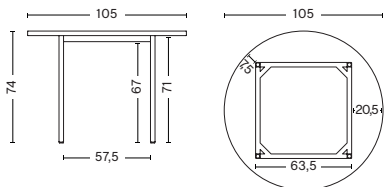

DIAMETER 105 CM | 41.34"
HEIGHT 74 CM | 29.13"

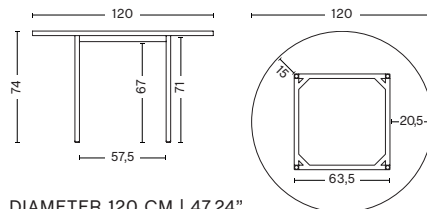

DIAMETER 120 CM | 47.24"
HEIGHT 74 CM | 29.13"

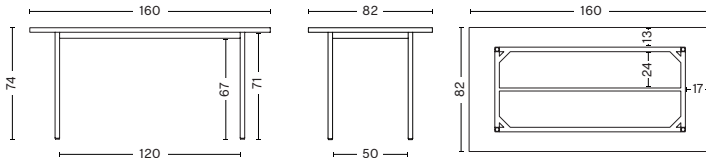

LENGTH 160 CM | 62.99"
WIDTH 82 CM | 32.28"
HEIGHT 74 CM | 29.13"

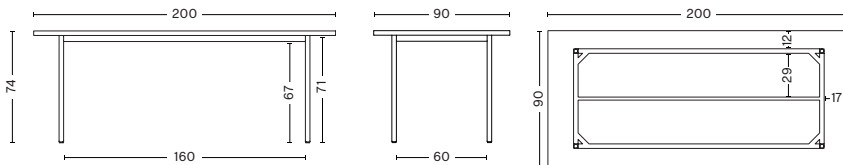

LENGTH 200 CM | 78.74"
WIDTH 90 CM | 35.43"
HEIGHT 74 CM | 29.13"

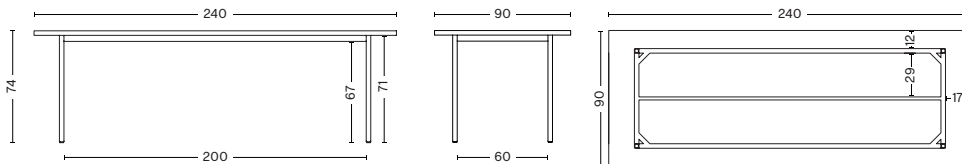

LENGTH 240 CM | 94.48"
WIDTH 90 CM | 35.43"
HEIGHT 74 CM | 29.13"

MATERIALS

TABLETOP

30 mm Valchromat, an organic coloured MDF material with water-based lacquer incl. a small amount of colour pigment. Visible wood fibres.

FRAME

Powder coated steel tube frame and legs. High gloss 90. Round tables with square support. Rectangular tables with rectangular support with centered cross bar.

ADJUSTABLE GLIDER

Integrated screw-in adjustable glider in plastic. Adjustable up to 12 mm.

CONSTRUCTION













Steel tube frame with tabletop in 30 mm coloured Valchromat. The frame is a knock-down construction that requires assembly. Legs are assembled to the frame with screws. Tabletop comes with threaded inserts, and is assembled to the frame with screws. The tables come with height adjustable gliders to handle any uneven floors.

COUNTRY OF ORIGIN

Denmark (tabletop).
China (frame).

COLOUR & FINISH

Please note that the colour codes are indicative.

	FRAME	OCHRE POWDER COATED STEEL  NCS S 3560 Y20R	MAROON RED POWDER COATED STEEL  RAL 3011	IVORY POWDER COATED STEEL  NCS S 1010 Y10R
TABLETOP				
LIGHT GREY WATER-BASED LACQUERED VALCHROMAT 				
BLUE WATER-BASED LACQUERED VALCHROMAT 				
RED WATER-BASED LACQUERED VALCHROMAT 				
GREEN MINT WATER-BASED LACQUERED VALCHROMAT 				

The material consists of natural wood fibres that give each table top a unique expression. The organic dyeing process means the fibres and colours vary slightly from batch to batch. Minor differences in the surface are a natural part of the material and may occur.

SUSTAINABILITY

HAY focuses on developing long-lasting products that minimise our environmental impact. We optimise the use of sustainable materials such as recycled materials, FSC-certified wood and water-based lacquer, with a growing number of eco-certified products. We have strict regulatory requirements, and the majority of our products are tested to comply with international standards for strength, durability and safety.

[LINK TO ENVIRONMENTAL PROFILE](#)

CERTIFICATES



FSC™ LABEL MIX

Made from FSC™-certified wood and other controlled materials.

TESTS

EN 15372: 2008

Furniture - Strength, durability and safety - Requirements for non-domestic tables.

L3: Severe use.

MÖBELFAKTA: 2019

Surface resistance, requirement category 5

WARRANTY

HAY provides a 5-year product warranty.

Please contact the HAY sales team for further information about the warranty terms and conditions.

CARE & MAINTENANCE

Our Care & Maintenance offers guidance for optimal maintenance of your HAY product. It includes advice and instructions on cleaning and caring for specific materials to prolong the life of your furniture. Find the guide at hay.com.

[LINK TO CARE & MAINTENANCE](#)

DOWNLOADS

Packshots and lifestyle photos, 2D / 3D files, care and maintenance, instructions, test certificates, product fact sheets, and product presentations are available in our Image Bank at hay.com.

[LINK TO IMAGE BANK](#)